

3 The provided 1' CAT5 CABLE (white cable) will be plugged into the green board, labeled CAT5-6/POE (shown in diagram 3A.) The other end will be plugged in to the left slot on the mounted Coupling in the back of the box (labeled 3b.) Then, plug the yellow cable (which represents your internet cable,) into the right CAT5/6 slot in the back of the box (this is the CAT5/6 coming from your internet provider.) This wire should go back to the POE switch provided.

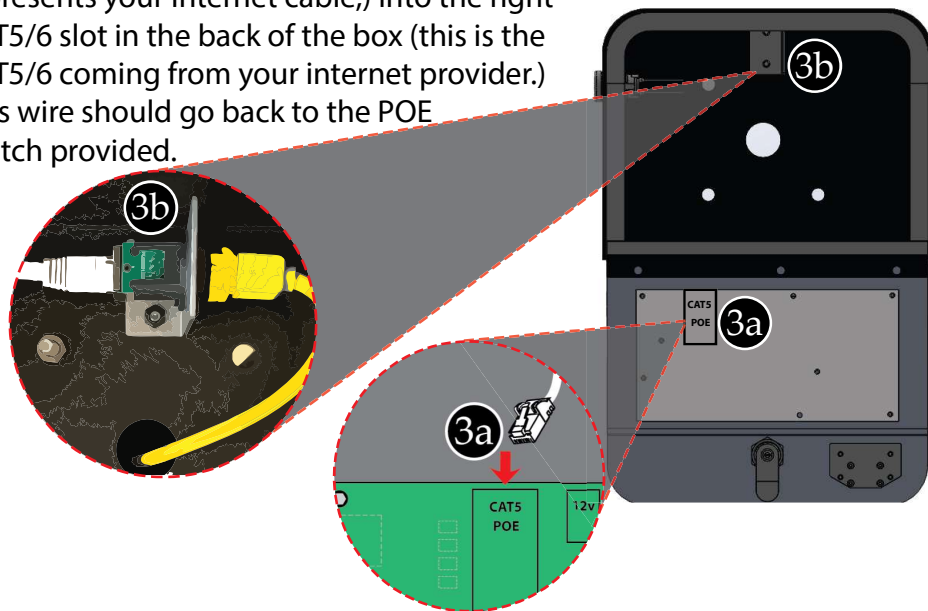

4 There are 2 wires coming from the manual key switch on the left side of the box (labeled 4a). Plug one those wires into the COM slot of relay 1 and the other will be inserted into the N/O slot of relay 1 (most gate systems use a N/O (Normally Opened) circuit to operate the gate, refer to your gate operations manual to verify).

Next, plug in the relay wires, which are attached to your gate operator. Using relay 1, (labeled 4b) plug one wire into the slot labeled COM (Common Wire) slot and plug the other wire into the N/O slot (Normally Opened).

NOTE: This keyed switch will allow a manager to open the gate easily with a key. Always keep key turned clockwise to keep the gate closed. Turn clockwise to open the gate.

Supplier's Declaration of Conformity
 47 CFR § 2.1077 Compliance Information
 Product Name: SpiderENTRY S22i
 Product Model: S22i
 Manufacturer: SpiderDoor
 7900 Gadsden Highway, Trussville, Al 35173
 www.spiderdoor.com

This device complies with Part 15 of the FCC Rules. Operation is subject to the following two conditions:
 (1) This device may not cause harmful interference, and (2) this device must accept any interference received, including interference that may cause undesired operation.

4 Continued...

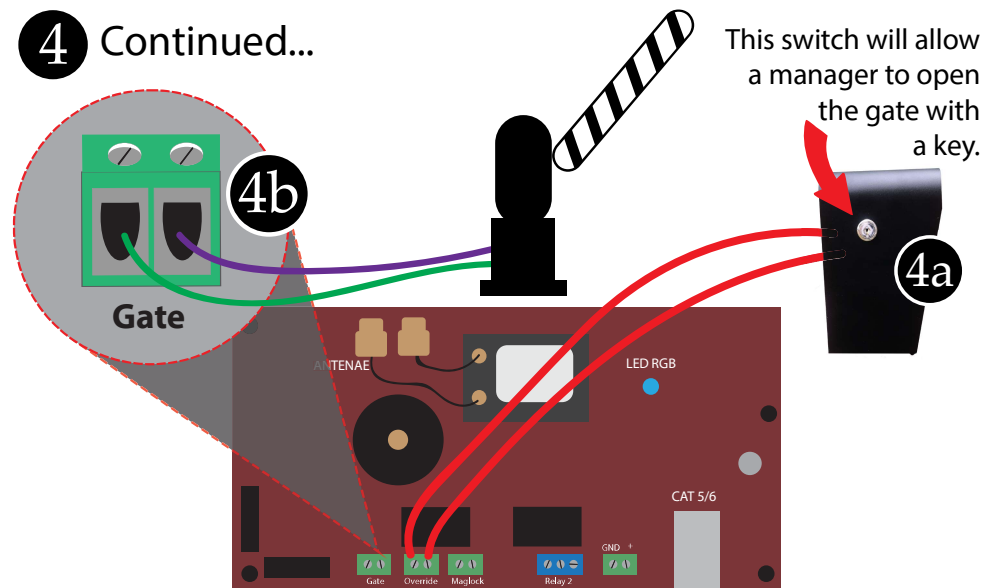

5 Plug a CAT5/6 cable from your current modem (coming from current internet provider - Orange cable) into the slot labeled "In" on POE Switch provided by SpiderENTRY. Then plug another CAT5/6 cable into slot labeled "OUT," on the POE SWITCH and this line will go straight to your SpiderENTRY keypad (Yellow Cable in diagram). This cable is what gives your keypad low voltage DC power that is needed to run the keypad. You must use the POE SWITCH provided. Plug into keypad.

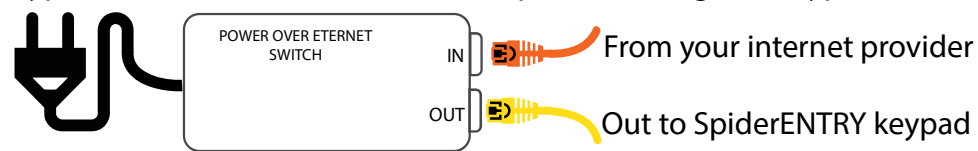

6 When the keypad powers up, you will see several lights on the PCB board. The green light (labeled 6b) will be solid and the orange flashing when properly connected to the router.

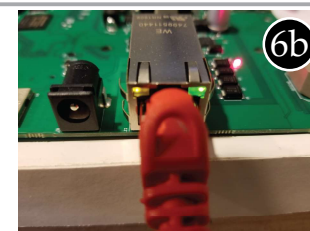

REQUIRED: Go to www.Spiderdoor.com to "Request Install" 24 hours in advance or email Support@Spiderdoor.com

7 If using a Magnetic lock for a walk through door, you will want to use N/C (normally closed) and the COM slot (common wire.) The two red wires coming from the manual open key on the left side of the box (illustration below.), those two wires should go inline with the common wire (green wire shown below, which goes to the magnetic lock installed on the walk through door.

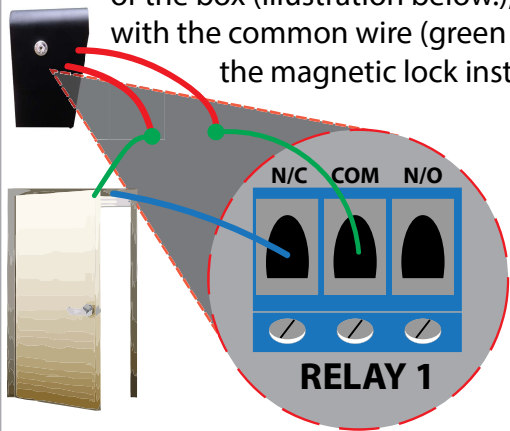

Keypad Sounds

ACTIVE CODE

A solid 4 second buzz means the gate code entered is a good code..

INACTIVE CODE

Three short beeps signifies that a code is INACTIVE or no good.

Owner/Manager Steps

Download Managers App! You will need login credentials, which will be provided to you by a Spiderdoor team member. Search App stores on your mobile device for the Spiderentry Managers App. Download the app and this will allow managers to access their gates from anywhere. Lastly, You can also login on your desktop at

https://app.spiderdoor.com/new_admin

This will allow you to view activity log, photos of tenants, (on certain keypad models) and open or latch open your gate, all from the Spiderdoor dashboard.

FCC Compliance Statement

CAUTION: The grantee is not responsible for any changes or modifications not expressly approved by the party responsible for compliance. Such modifications could void the user's authority to operate the equipment.

NOTE: This equipment has been tested and found to comply with the limits for a Class A digital device, pursuant to Part 15 of the FCC Rules. These limits are designed to provide reasonable protection against harmful interference in a commercial installation. This equipment generates, uses, and can radiate radio frequency energy, and if not installed and used in accordance with the instructions, may cause harmful interference to radio communications. However, there is no guarantee that interference will not occur in a particular installation. If this equipment does cause harmful interference to radio or television reception, which can be determined by turning the equipment off and on, the user is encouraged to try to correct the interference by one or more of the following measures:

- Reorient or relocate the receiving antenna.
- Increase the separation between the equipment and receiver.
- Connect the equipment into an outlet on a circuit different from that to which the receiver is connected.
- Consult the dealer or an experienced radio/TV technician for help.



SpiderENTRY (619) 489-6959

INSTALL GUIDE



1 Unpack the box and make sure you have all items shown below.

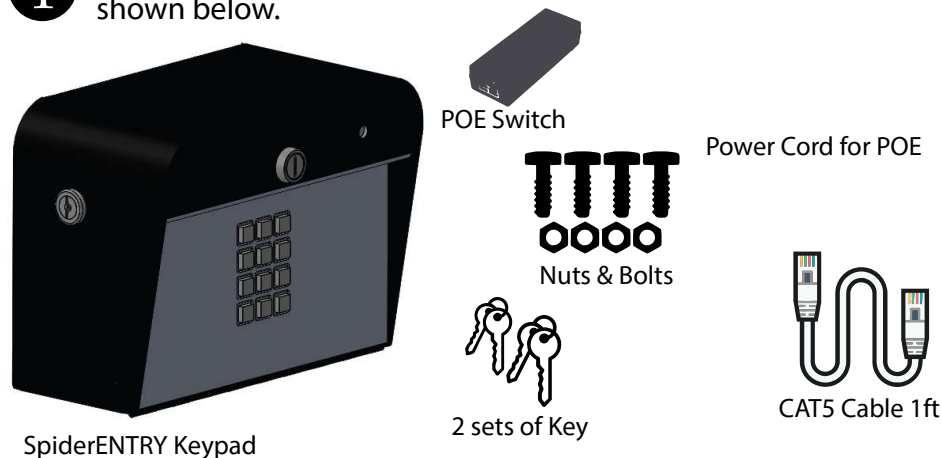

2 Unlock and open the front door to install and wire properly. Door will swing forward.

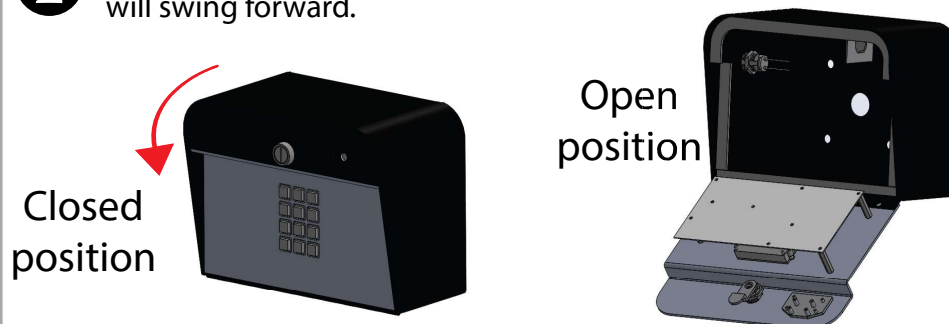

Mount the box to the pedestal using the four holes in the back of the box. 4 bolts and 4 nuts are provided. Be sure to pull the CAT5/6 wire through the open hole in the middle of the box.

WARNING

AUTOMATIC GATE CAN CAUSE SERIOUS INJURY OR DEATH!

ALWAYS CHECK THAT THE GATE PATH IS CLEAR PRIOR TO OPENING!
SAFETY REVERSING DEVICES SHOULD ALWAYS BE USED!